

 **Ryan Marine Inc.**
N41°31.48'W70°40.25'
Partnered With  **GO** GUICEOFFSHORE

M/V GO AMERICA

150' CLASS DP1 MULTIPURPOSE SUPPORT AND SUBSEA VESSEL





M/V GO AMERICA

150' CLASS DP1 MULTIPURPOSE SUPPORT AND SUBSEA VESSEL

HULL SPECIFICATIONS

Length:	150'
Beam:	36'
Depth:	11' 6"
Draft Max:	10'
Clear Deck:	90' x 30'

CAPACITIES

Deck Cargo:	330 LT
Potable Water:	14,982 usg
Fuel:	31,497 usg / 77,163 usg* / 97,735 usg**
Ballast Water:	75,928 usg
Liquid Mud:	1,087 bbls
Methanol:	41,572 usg

*Fuel capacity when utilizing Liquid Mud tanks

** Fuel capacity when utilizing Liquid Mud and Methanol tanks

PROPULSION

Main Engines (New 2014):	2 x Cummins KTA 38MO
Total HP:	1,700 HP
Reduction Gears:	Twin Disc
Generators:	2 x 99kW Cummins
Bow Thruster:	360 HP, Diesel Driven

ACCOMMODATIONS

Certified to Carry:	20
Cabins / Berths:	6 / 18 + Passenger Lounge
Walk in Cooler:	Yes
Commercial Ice Maker:	Yes

ELECTRONICS

Radars:	Yes x 2
Auto Pilot:	Beier Integrated Systems
GPS (Navigation):	Yes
Echo Sounder:	Yes x 1
VHF Radios:	Yes x 3
Dynamic Positioning:	Beier Integrated Systems
DP Reference System:	GPS
Electronic Plotter:	Yes
Sat Communication:	Vsat, Speeds up to 1024kbps x 1024kbps
Sat Television:	DirecTV

DOCUMENTATION

US Flag:	USCG, ON 1120138
Class:	ABS Loadline, USCG Sub
Builder:	Bollinger Shipyards
Delivery Date:	2001
EEP:	110 Persons

SPECIAL EQUIPMENT

Fire Monitor:	Yes
Deck Cargo Sockets:	240 in a NATO Grid Pattern, 2' x 2'
Crane:	Palfinger PK-32002-M Knuckleboom (see lifting capacity diagram)
A-Frame:	Transom Mounted, 11-ton with Man-rated Braden CH280 Winch, Frame Inside Dimension: 30'h x 25'w
HPU for Deck Gear:	Twin (redundant) 50-Hp Hydraulic Power Unit configured w/cross-over manifold to allow either HPU to serve Crane, A-Frame or both
Moonpool:	27" Inside Diameter (Transponder pole, submersible tracking and comms available upon request)
Steering Gear:	Dual Independent, Dual Ram Rudders Integrated with DP controls and Redundant HPU
FRC w/ Davit:	Removable Bulwarks 10' Starboard side, 3' Port side USCG / SOLAS 4m Rescue Boat with 40 hp outboard

OPTIONAL EQUIPMENT AND SERVICES

Triton 1000/2:	(2) ABS class, LED lighting, USBL Tracking/Navigation, manipulator arm, digital photography/video system, 305m max depth
Triton 3300/3:	(2) ABS class, LED lighting, USBL Tracking/Navigation, manipulator arm, digital photography/video system, 1000m max depth
DECO Chambers:	54-inch and 60-inch DDC
Portable Dive Locker:	20' Conex, with HalcyonDive Systems gear for (6) Exploration Divers
Portable Deck Generator :	97Kw diesel, 460v, 60Hz, 3-phase w/Hubbell 4100R7W cable connector
Mixed Gas Dive System:	NITROX/TRIMIX Maker, BAUER HP Compressors, Boost Pumps and Twin-tank/Rebreather support equipment
Diver Propulsion Vehicles:	(8) long-range tow-behind Halcyon Dive Vehicles (SUEX); 3 & 5 mile range at 500Fsw operating depth. Speed: 200-375 Ft Per Min
Camera Equipment:	Underwater Video, Still, Laser Scale, Benthic and Stereo Camera Systems



M/V GO AMERICA

150' CLASS DP1 MULTIPURPOSE
SUPPORT AND SUBSEA VESSEL

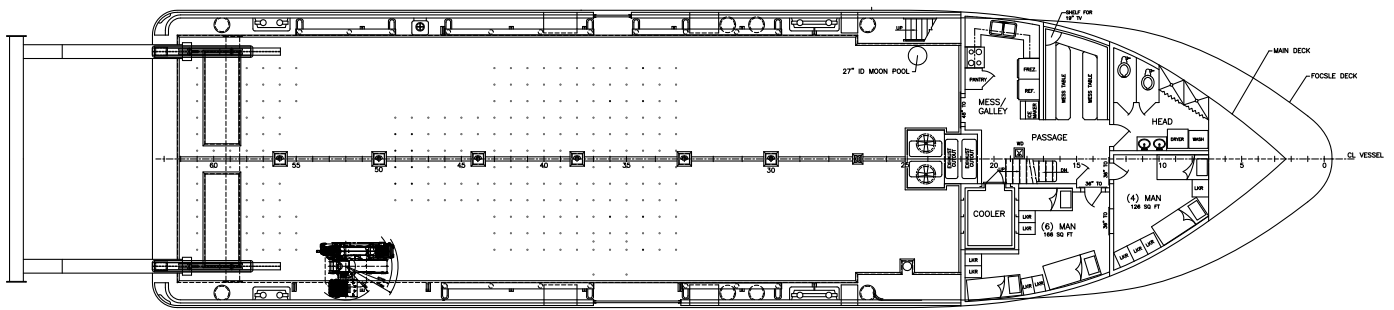
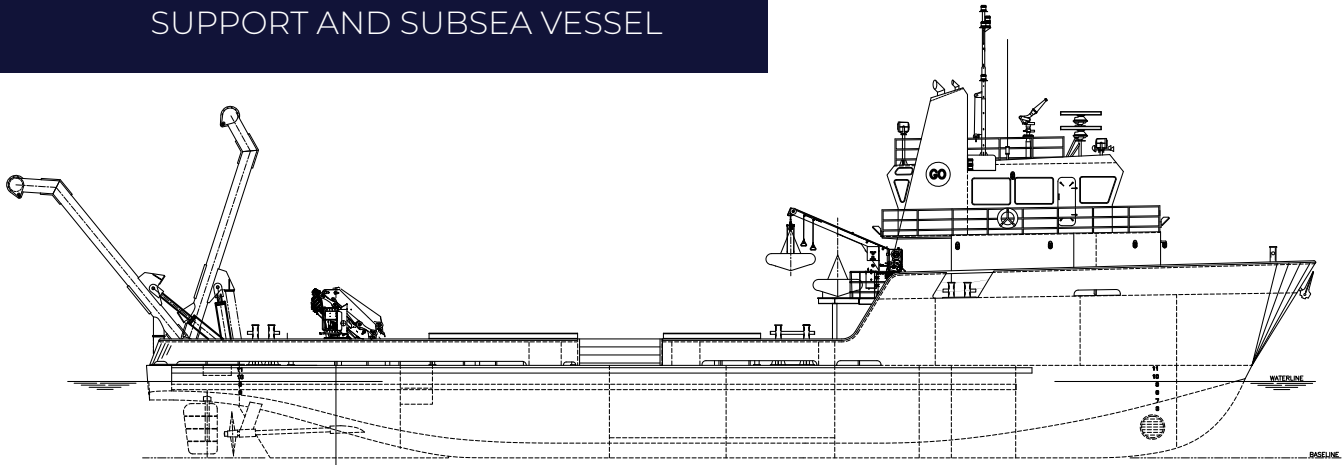

MAIN DECK ARRANGEMENT

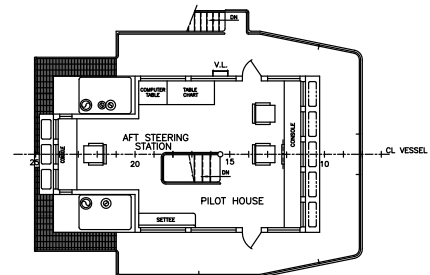
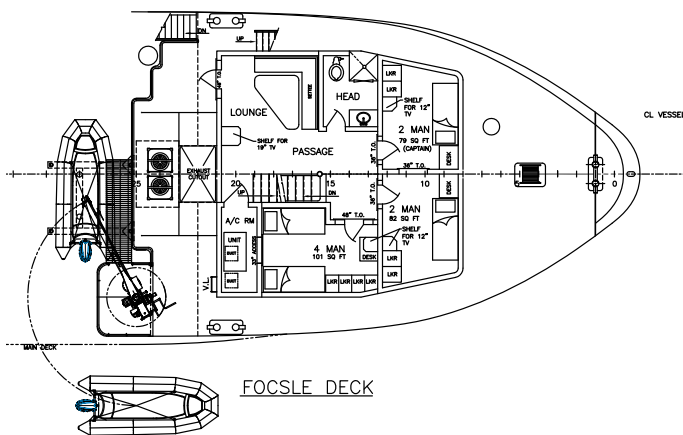

PILOTHOUSE ARRANGEMENT